

PROJECT NO.	SHEET NO.	TOTAL NO.
2021CPT.11.03.10061	1	2
2021CPT.11.03.10951		
2021CPT.11.03.20061		
2021CPT.11.03.20952		

SUMMARY OF QUANTITIES

Project No.	County	Map No.	Route	Route Name	From Description	To Description	Mile Post From	Mile Post To	TYP NO	LANES	LANE TYPE	LENGTH	WIDTH	0106000000-E	1220000000-E	1245000000-E	1308000000-E	1330000000-E	1519000000-E	1520000000-E	1575000000-E	1704000000-E	6084000000-E									
														BORROW	INCIDENTAL STONE BASE	SHOULDER RECONSTRUCTION	0-1.5" MILLING	INCIDENTAL MILLING	SURFACE COURSE, S9.5B	LEVELING COURSE, S9.5B	ASPHALT BINDER FOR PLANT MIX	PATCHING EXISTING ASPHALT	SEED & MULCHING									
													MI	FT	CY	TONS	SMI	SY	SY	TONS	TONS	TONS	TONS	AC								
2021CPT.11.03.10061	Avery	1	US 221	Linville Falls Hwy	Burke Co Line	SR 1148	0.00	5.20	1	2	2WU	5.20	24	1,040	104	10.40	533	200	6,644		445	664	3.78									
TOTAL FOR PROJECT NO. 2021CPT.11.03.10061																																
2021CPT.11.03.20061	Avery	2	SR 1503	Mill Timber Crk Rd	US 221	EOM	0.00	0.50	2	2	2WU	0.50	16		10				426	129	37											
2021CPT.11.03.20061	Avery	3	SR 1504	Pineola Rd	SR 1505	US 221	0.32	0.91	2	2	2WU	0.59	16		10				503	152	44											
2021CPT.11.03.20061	Avery	4	SR 1505	Pineola Baptist Ch Rd	US 221	SR 1504	0.00	0.19	2	2	2WU	0.19	18		10				182	55	16											
2021CPT.11.03.20061	Avery	5	SR 1543	Goose Hollow Rd	SR 1501	SR 1501	0.00	1.46	2	2	2WU	1.46	18		10				1,399	424	122											
TOTAL FOR PROJECT NO. 2021CPT.11.03.20061																																
2021CPT.11.03.10951	Watauga	6	US 421	US 421	SR 1420	TN State Line	25.04	26.54	3	2	2WU	1.50	35	300	30	3.00		500	2,795		187	280	1.09									
TOTAL FOR PROJECT NO. 2021CPT.11.03.10951																																
2021CPT.11.03.20951	Watauga	7	SR 1104	Hodges Gap Rd	SR 1107	SR 1146	0.00	1.06	2	2	2WU	1.06	20	0	10	0.00	0	200	1,129		76	0	0.00									
TOTAL FOR PROJECT NO. 2021CPT.11.03.20951																																
GRAND TOTAL																																
													10.50		1,340	184	13.40	533	900	13,078	761	927	944	4.87								

PROJECT NO.	SHEET NO.	TOTAL NO.
2021CPT.11.03.10061	2	2
2021CPT.11.03.10951		
2021CPT.11.03.20061		
2021CPT.11.03.20951		

THERMOPLASTIC AND PAINT QUANTITIES

Project No.	County	Map No.	Route	Route Name	From Description	To Description	Mile Post From	Mile Post To	TYP NO	LANES	LANE TYPE	LENGTH	WIDTH	4413000000-E	4457000000-N	4810000000-E		4845000000-N	4905000000-N
														WORK ZONE ADVANCE/GENERAL WARNING SIGNING	TEMPORARY TRAFFIC CONTROL	4" WHITE PAINT	4" YELLOW PAINT	PAINT MERGE ARROW	SNOW PLOWABLE MARKERS
														SF	LS	LF	LF	EA	EA
2021CPT.11.03.10061	Avery	1	US 221	Linville Falls Hwy	Burke Co Line	SR 1148	0.00	5.20	1	2	2WU	5.20	24	650	1	109,824	109,824		343
TOTAL FOR PROJECT NO. 2021CPT.11.03.10061													650	1	109,824	109,824	0	343	
													219,648						
2021CPT.11.03.20061	Avery	2	SR 1503	Mill Timber Crk Rd	US 221	EOM	0.00	0.50	2	2	2WU	0.50	16						
2021CPT.11.03.20061	Avery	3	SR 1504	Pineola Rd	SR 1505	US 221	0.32	0.91	2	2	2WU	0.59	16						
2021CPT.11.03.20061	Avery	4	SR 1505	Pineola Baptist Ch Rd	US 221	SR 1504	0.00	0.19	2	2	2WU	0.19	18						
2021CPT.11.03.20061	Avery	5	SR 1543	Goose Hollow Rd	SR 1501	SR 1501	0.00	1.46	2	2	2WU	1.46	18						
TOTAL FOR PROJECT NO. 2021CPT.11.03.20061													0	0	0	0	0	0	
2021CPT.11.03.10951	Watauga	6	US 421	US 421	SR 1420	TN State Line	25.04	26.54	3	2	2WU	1.50	35	188		39,600	31,680	6	132
TOTAL FOR PROJECT NO. 2021CPT.11.03.10951													188	0	39,600	31,680	6	132	
													71,280						
2021CPT.11.03.20951	Watauga	7	SR 1104	Hodges Gap Rd	SR 1107	SR 1146	0.00	1.06	2	2	2WU	1.06	20						
TOTAL FOR PROJECT NO. 2021CPT.11.03.20061													0	0	0	0	0	0	
Grand Total													838	1	149,424	141,504	6	475	
													290,928						

8/17/99

* "PATCHING EXISTING PAVEMENT" AND LEVELING HAVE BOTH BEEN INCLUDED AS A PAY ITEM ON MAPS. PATCHING MAY OR MAY NOT BE NEEDED DEPENDING ON CONDITION OF MAP SURFACE AT TIME THAT PAVING SEASON BEGINS. AREAS TO BE DELINIATED BY THE ENGINEER.

* INCIDENTAL MILLING AT LOCATIONS AS DIRECTED BY THE ENGINEER

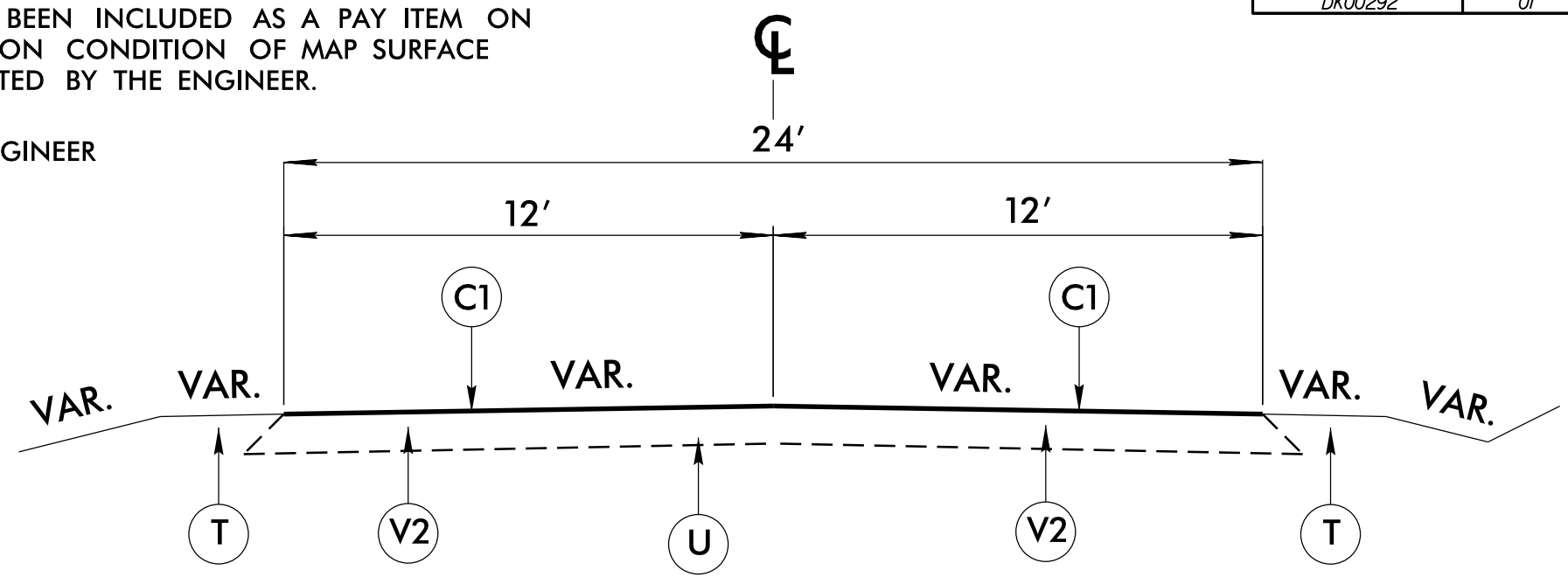
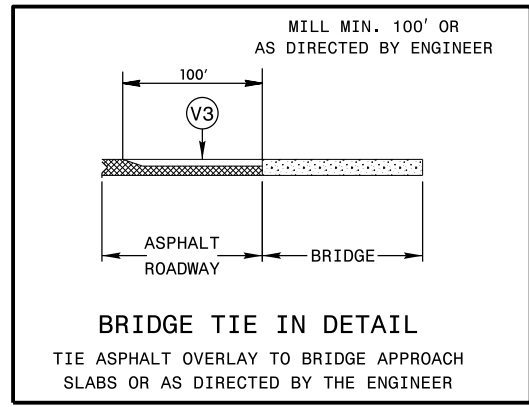
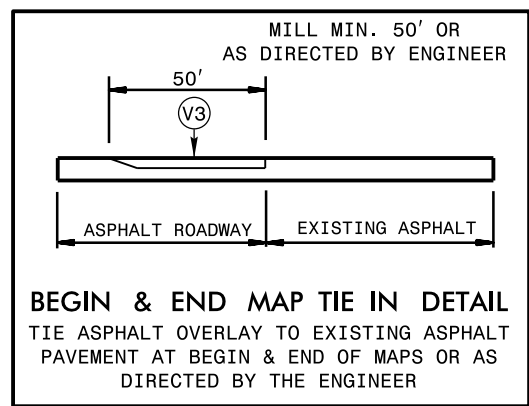

TYPICAL SECTION NO. 1
MAP 1 - US 221 FROM BURKE CO. LINE TO SR 1148

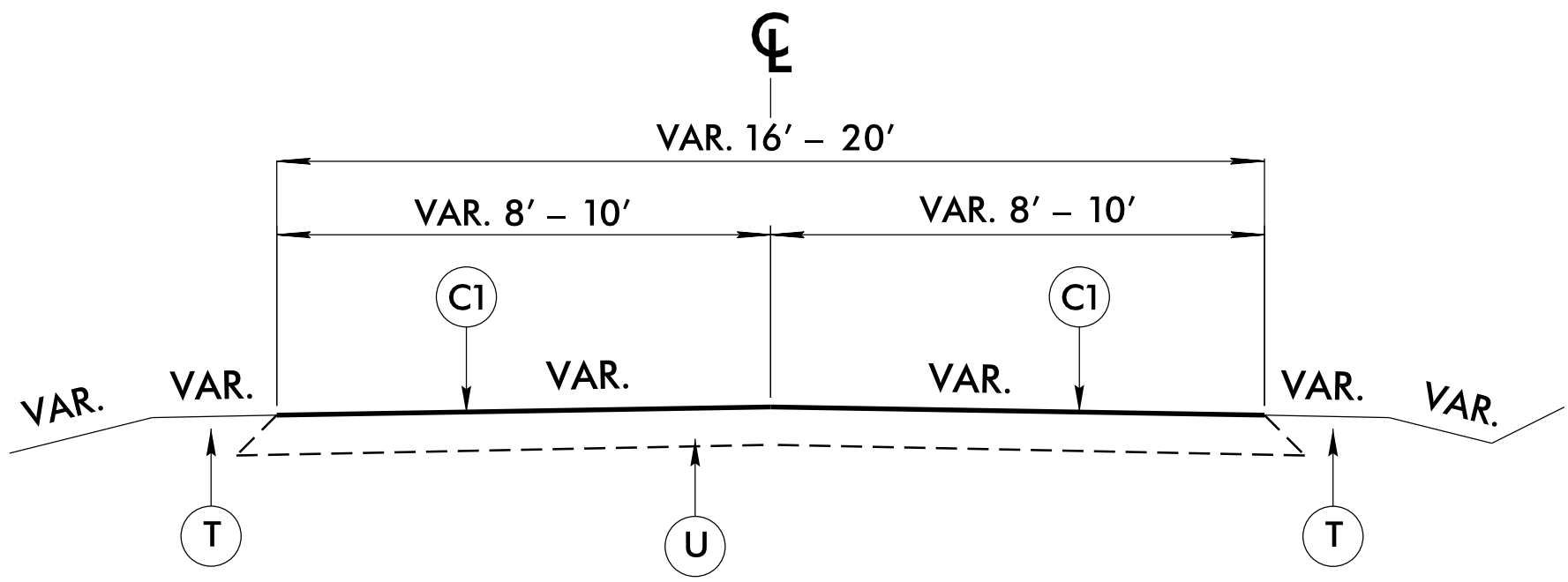

TYPICAL SECTION NO. 2

- MAP 2 - SR 1503 FROM US 221 TO EOM
- MAP 3 - SR 1504 FROM SR 1505 TO US 221
- MAP 4 - SR 1505 FROM US 221 TO SR 1504
- MAP 5 - SR 1543 FROM SR 1501 TO SR 1501
- MAP 7 - SR 1104 FROM SR 1107 TO SR 1146

PAVEMENT SCHEDULE

C1	PROP. APPROX. 1 1/2" ASPHALT CONCRETE SURFACE COURSE, TYPE S9.5B, AN AVERAGE RATE OF 165 LBS. PER SQ. YD.
T	SHOULDER RECONSTRUCTION
U	EXISTING PAVEMENT
V2	MILLING OF EXISTING ASPHALT PAVEMENT AT DEPTH OF 0 TO 1 1/2"
V3	INCIDENTAL MILLING (See Tie in Detail)

**AVERY & WATAUGA COUNTY
PRIMARY AND SECONDARY ROADS
ASPHALT RESURFACING**

REVISIONS	INT.	DATE

N.C. DEPARTMENT of TRANSPORTATION
DIVISION of HIGHWAYS
DIVISION ELEVEN

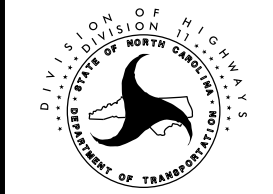

SCALE: N/A DATE: 2/5/2021
PREPARED BY: GKirby
REVIEWED BY:
REVIEWED BY:

05-FEB-2021 09:50
\\s01\p01\work\resurfacing-typicals01.dgn

8/17/99

- * "PATCHING EXISTING PAVEMENT" AND LEVELING HAVE BOTH BEEN INCLUDED AS A PAY ITEM ON MAPS. PATCHING MAY OR MAY NOT BE NEEDED DEPENDING ON CONDITION OF MAP SURFACE AT TIME THAT PAVING SEASON BEGINS. AREAS TO BE DELINIATED BY THE ENGINEER.
- * INCIDENTAL MILLING AT LOCATIONS AS DIRECTED BY THE ENGINEER

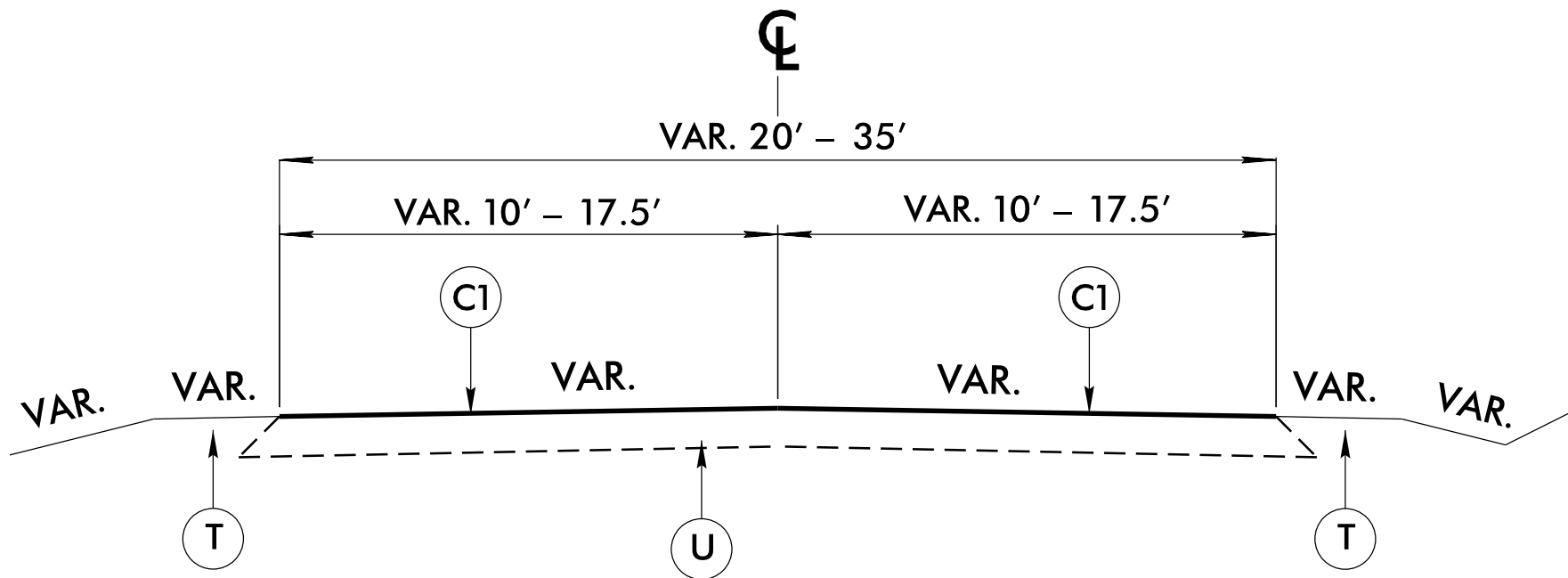
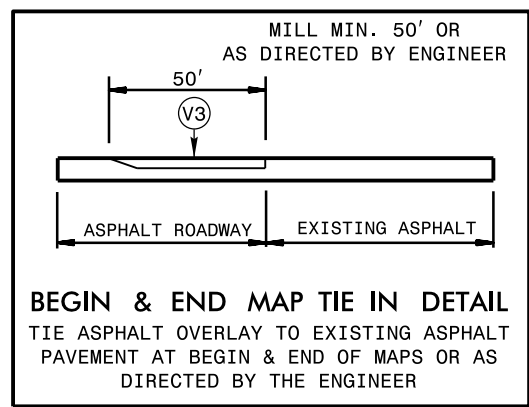
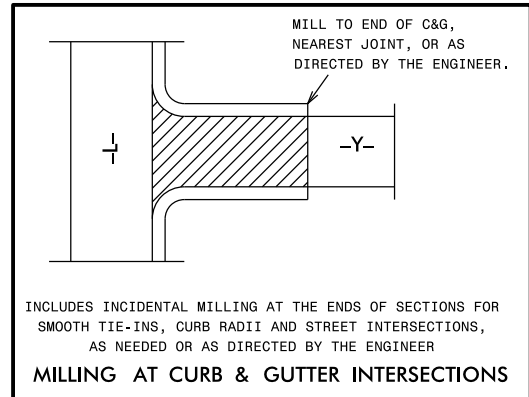

TYPICAL SECTION NO. 3

MAP 6 - US 421 FROM SR 1420 TO TN. STATE LINE

PAVEMENT SCHEDULE	
C1	PROP. APPROX. 1½" ASPHALT CONCRETE SURFACE COURSE, TYPE S9.5B, AN AVERAGE RATE OF 165 LBS. PER SQ. YD.
T	SHOULDER RECONSTRUCTION
U	EXISTING PAVEMENT
V1	MILLING OF EXISTING ASPHALT PAVEMENT AT DEPTH OF 1½"
V3	INCIDENTAL MILLING (See Tie in Detail)

AVERY & WATAUGA COUNTY PRIMARY AND SECONDARY ROADS ASPHALT RESURFACING		
REVISIONS		
INT.	DATE	
N.C. DEPARTMENT of TRANSPORTATION DIVISION of HIGHWAYS DIVISION ELEVEN		SCALE: N/A DATE: 2/5/2021 PREPARED BY: GKirby REVIEWED BY: REVIEWED BY:

05-FEB-2021 09:46
\\S:\GIS\PROJECTS\2021\02\resurfacing-typicals02.dgn

AVERY COUNTY

2021 RESURFACING
MAP # 1, # 2, # 3, # 4, & #5

MAP #5

★ SR 1543 - (1.46mi.)
(FROM SR 1501 TO SR 1501)



MAP #4

★ SR 1505 - (0.19mi.)
(FROM US 221 TO SR 1504)

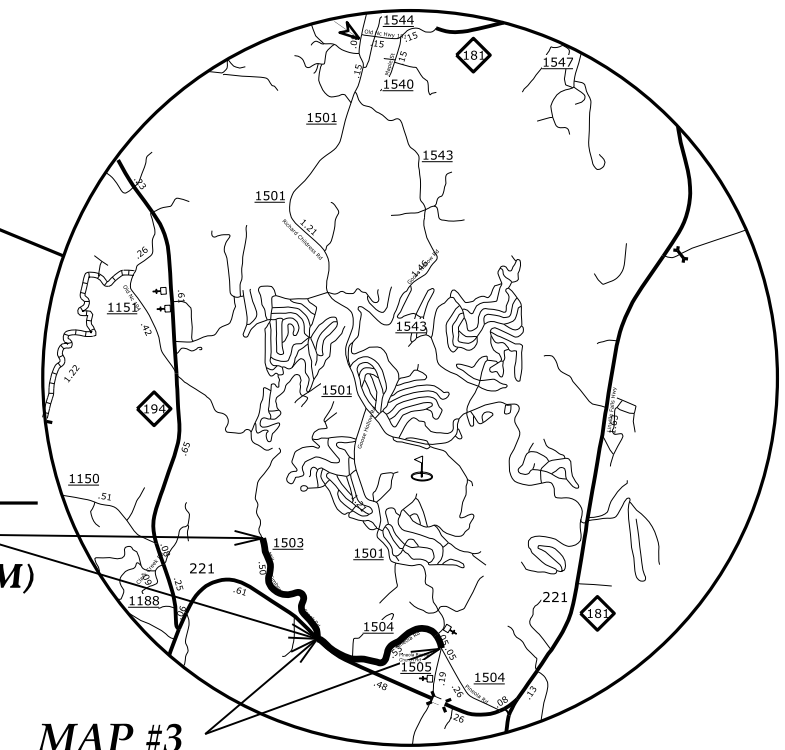

MAP #3

★ SR 1504 - (0.59mi.)
(FROM SR 1505 TO US 221)

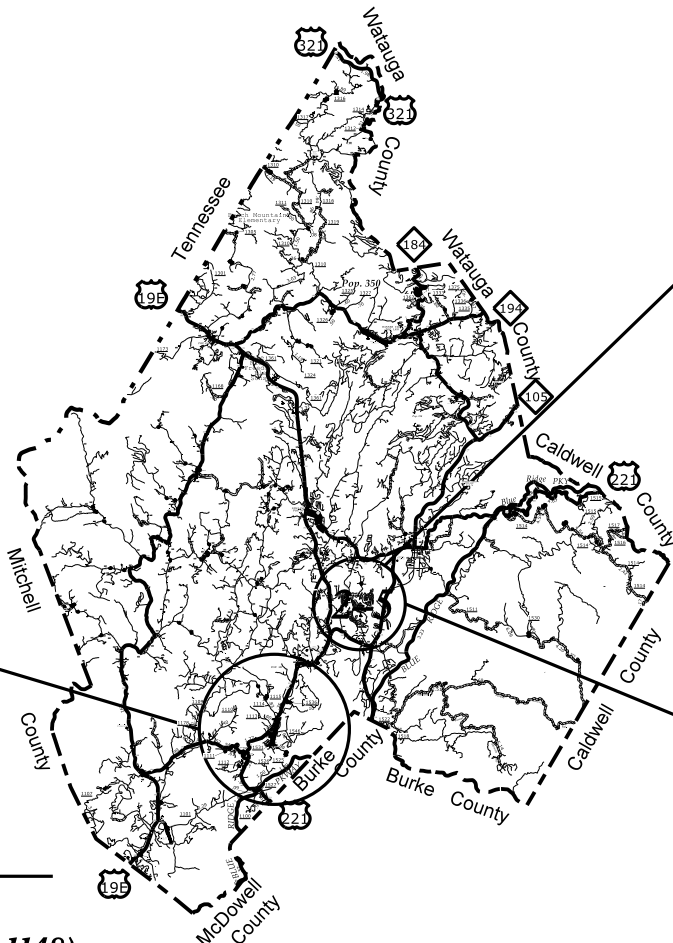

MAP #2

★ SR 1503 - (0.50mi.)
(FROM US 221 TO EOM)

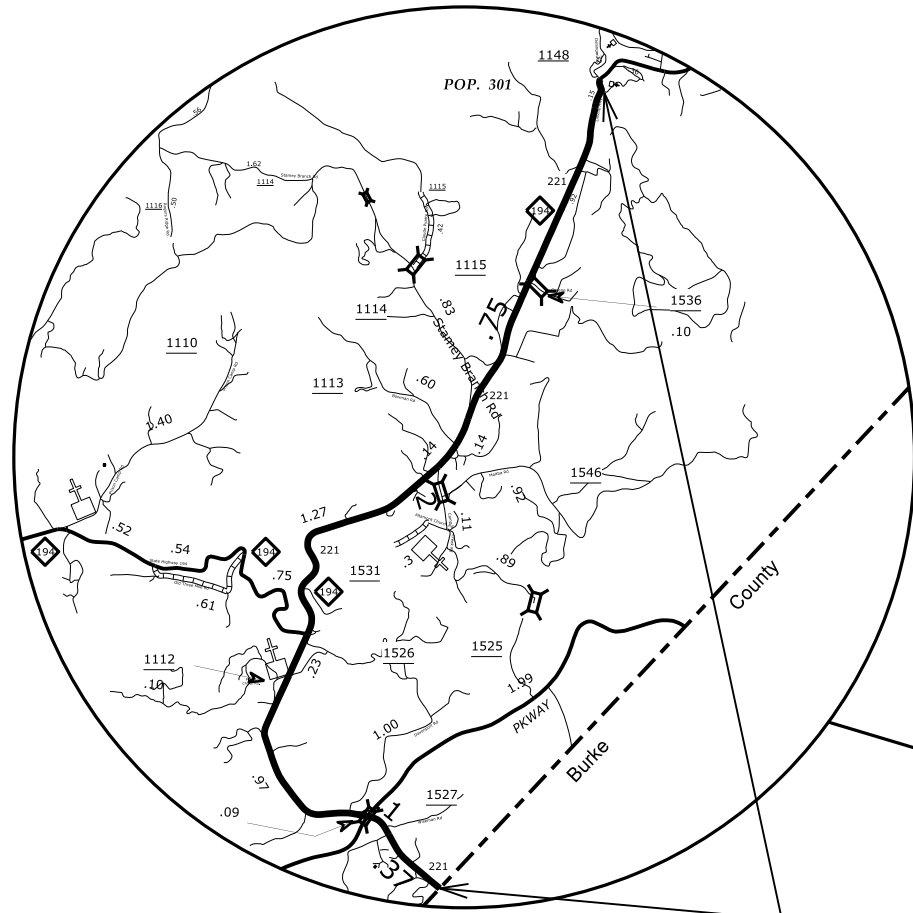

MAP #1

★ US 221 - (5.20mi.)
(FROM BURKE CO. LINE TO SR 1148)



WATAUGA COUNTY

2021 RESURFACING
MAP # 6 & # 7

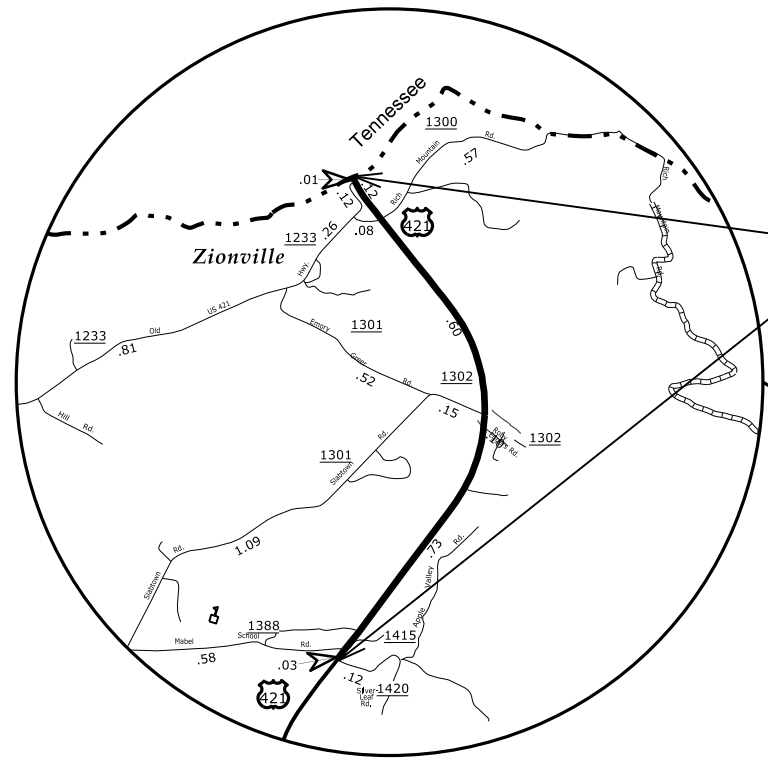
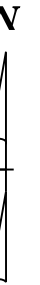

MAP #6
★ US 421 – (1.50mi.)
(FROM SR 1420 TO TN STATE LINE)

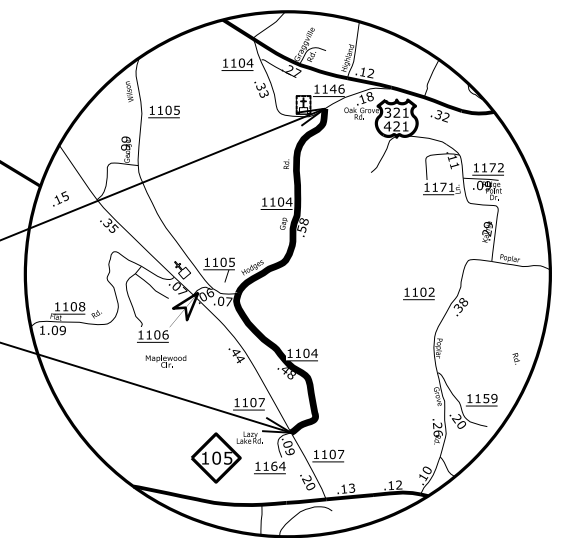
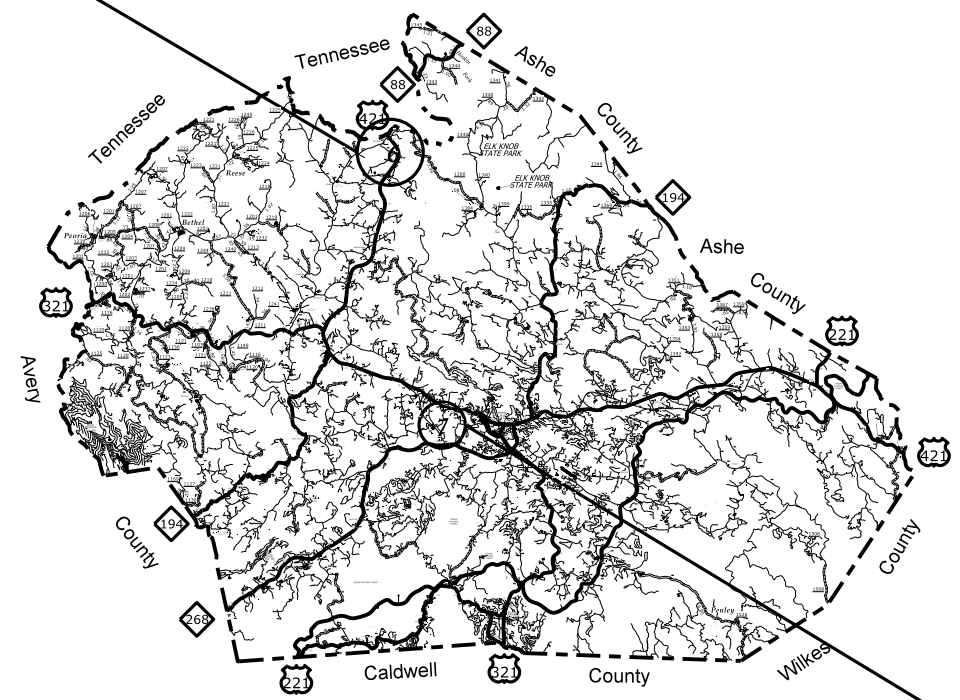

MAP #7
★ SR 1104 – (1.06mi.)
(FROM SR 1107 TO SR 1146)

SIGNING FOR RESURFACING PROJECTS

LEGEND

┃ STATIONARY SIGN

← DIRECTION OF TRAFFIC FLOW

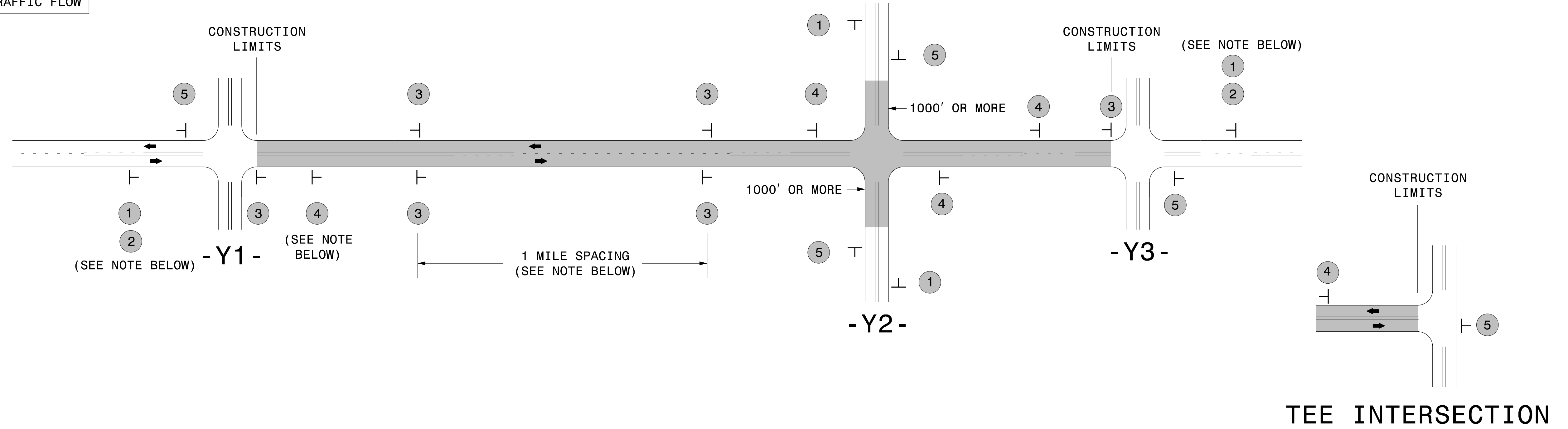

MAINLINE (-L-) SIGNING

-Y- LINE SIGNING

SIGNING NOTES AND PLACEMENT PER DIRECTION	1	 W20-1 48" X 48"	PLACE 1000' PRIOR TO BEGINNING OF CONSTRUCTION LIMITS. ONLY USED ON -Y- LINES IF RESURFACING LIMITS EXTEND 1000' ALONG -Y- LINE.	NO REQUIRED STATIONARY SIGNING FOR THE FOLLOWING -Y- LINE CONDITIONS: 1) LESS THAN 1000' OF RESURFACING ALONG -Y- LINE 2) SUBDIVISION ROADS 3) DEAD END ROADS WHEN PAVING/CONSTRUCTION ACTIVITIES PROCEED ACROSS AN UNSIGNED -Y- LINE, PORTABLE ADVANCE WARNING SIGNS SHALL BE USED ALONG THE -Y- LINE AS SHOWN BELOW. REMOVE UPON COMPLETION OF WORK. <div style="display: flex; justify-content: space-around;"> <div style="text-align: center;"> W20-1 48" X 48" PLACED 500' IN ADVANCE OF FLAGGER. </div> <div style="text-align: center;"> W20-7 A 48" X 48" PLACED 250' IN ADVANCE OF FLAGGER. </div> </div>
	2	 W7-3aP 24" X 18"	#2 SIGN ONLY USED WHEN CONSTRUCTION LIMITS ARE 2 OR MORE MILES IN LENGTH. ROUND UP TO NEXT WHOLE NUMBER. (NO FRACTIONAL OR DECIMAL NUMBERS)	
	3	 SP 13107 48" X 48"	- PLACE INITIALLY AT THE CONSTRUCTION LIMITS AND SPACE 1 MILE APART THEREAFTER. - AT TEE INTERSECTIONS INSTALL INITIALLY 1/2 MILE FROM INTERSECTION AND SPACE 1 MILE APART THEREAFTER.	
	4	 SP 13106 48" X 48"	- THESE ARE FOR -Y- LINES THAT ARE "THROUGH" ROADWAYS. - DEAD END AND SUBDIVISION ROADS ARE NOT "THROUGH" ROADWAYS. - INSTALL 500' +/- FROM EACH -Y- LINE APPROACH AS SHOWN ABOVE. - FOR MULTIPLE -Y- LINES THAT ARE SEPARATED BY 0.25 MILES OR LESS, TREAT AS A SINGLE UNIT AND INSTALL WITHIN 500' OF EACH APPROACH. - A MAXIMUM OF 2 SIGN SETS PER MILE. DO NOT INSTALL WHEN -Y- LINES ARE WITHIN 0.5 MILES FROM "END ROAD WORK" SIGN. - FOR TEE INTERSECTIONS, INSTALL WITHIN 500' +/- OF THE INTERSECTION ALONG -L- LINE.	
	5	 G20-2 A 48" X 24"	PLACE 500' FOLLOWING THE END OF CONSTRUCTION LIMITS OR AS SHOWN WHEN WORK ENDS AT A 3-WAY TEE INTERSECTION.	

THE ABOVE SIGNS ARE ALL THAT ARE REQUIRED FOR A CONTRACTOR TO BEGIN A RESURFACING CONTRACT. ANY ADDITIONAL SIGNS REQUESTED BY NCDOT DIVISIONS SHALL BE INSTALLED WITHIN 7 BUSINESS DAYS OF THE START OF CONTRACT WORK.

MAPS LESS THAN 2 MILES

FOR RESURFACING MAPS WITH CONSTRUCTION LIMITS LESS THAN 2 MILES IN LENGTH, NO STATIONARY SIGNS ARE REQUIRED. USE PORTABLE "ROAD UNDER CONSTRUCTION" OR "ROAD WORK AHEAD" SIGNS IN LIEU OF STATIONARY ADVANCE WARNINGS SIGNS.

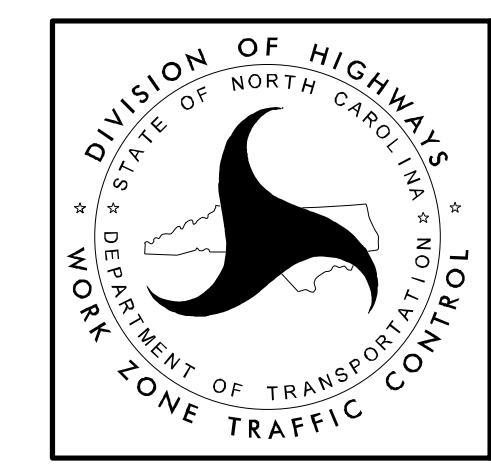

ADVANCE WARNING SIGNS FOR RURAL AND SUBURBAN 2-LANE ROADWAY RESURFACING

- NOTES:
- 1) DETAIL DOES NOT APPLY TO OGAFc AND ULTRA-THIN BONDED WEARING COURSE.
 - 2) BACKFILL SHOULDER WITH APPROVED MATERIAL.
 - 3) THE SHOULDER WEDGE DEVICE MAY BE DISENGAGED AT PAVED DRIVEWAYS AND SIDE STREETS.

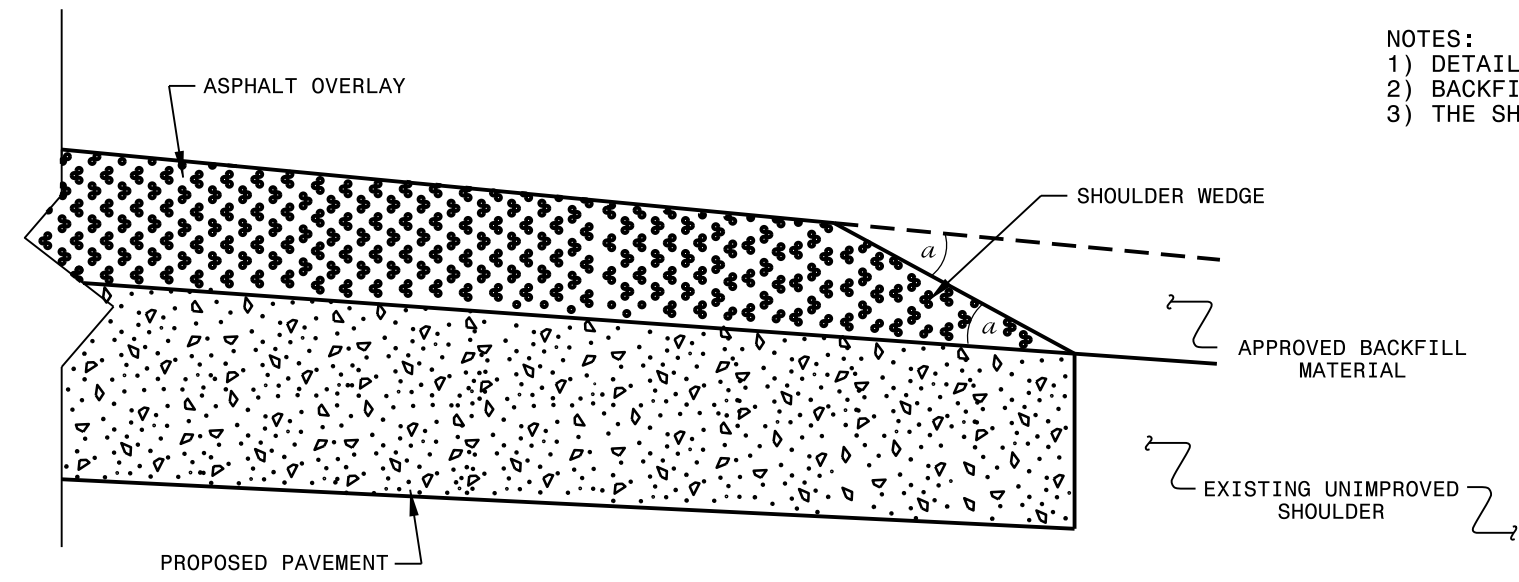

SHOULDER WEDGE DETAIL
 (Resurfacing Projects w/ Widening or
 with Existing Paved Shoulder having no dropoffs)

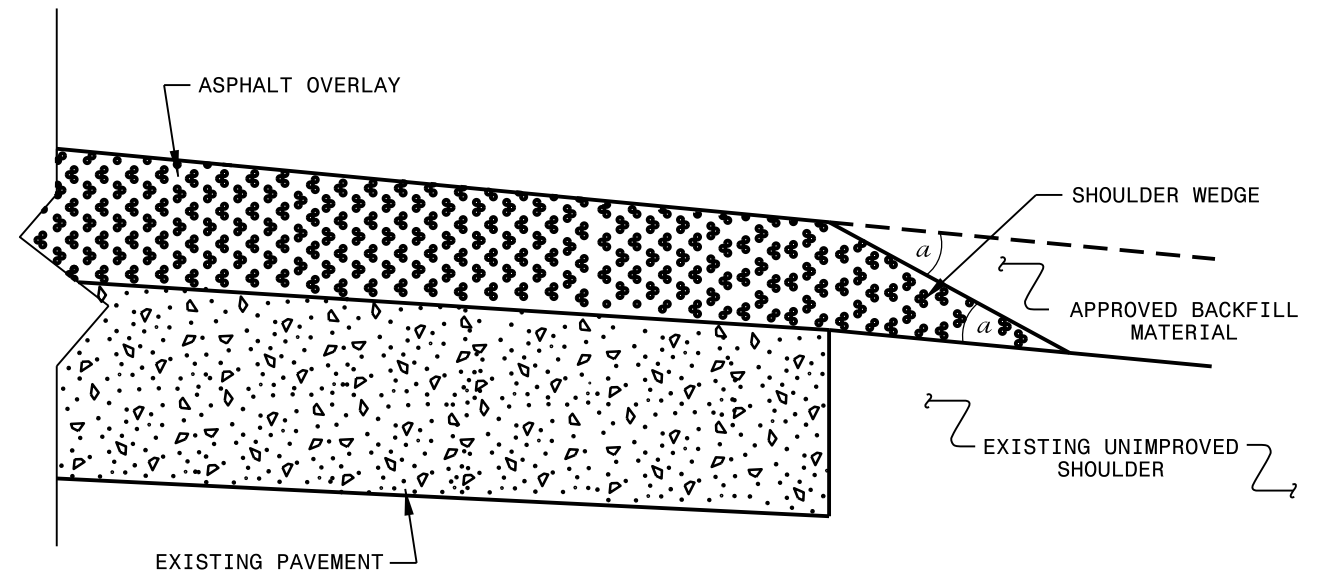

SHOULDER WEDGE DETAIL
 (Resurfacing Projects w/ NO Widening)

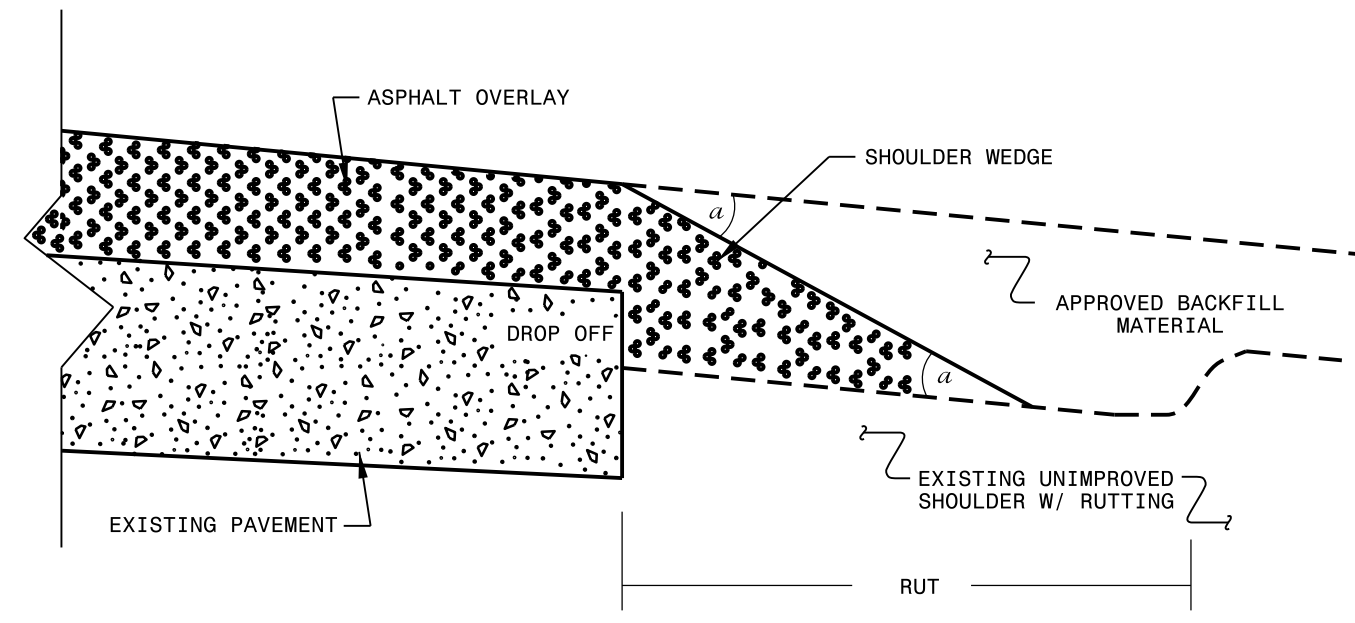

SHOULDER WEDGE DETAIL
 (Resurfacing Adjacent to
 Rutted Shoulder)

- SHOULDER WEDGE ANGLE = 30°

CONTRACT STANDARDS
 AND DEVELOPMENT UNIT
 Office 919-707-6950 FAX 919-250-4119

**SHOULDER WEDGE
 DETAILS**

ORIGINAL BY: T.SPELL DATE: 7-19-11
 MODIFIED BY: DATE: 10/16/12
 CHECKED BY: DATE:
 FILE SPEC.: susr/details/stand/shoulderwedgedetail.dgn

SYSTEMS DESIGN
 USER NAME